

The Corporation of the City of Adelaide does not warrant that the areas, measurements and sitings specified or appearing on this Plan are a true and accurate record and the Corporation accepts no responsibility to persons relying or acting on the accuracy of anything contained in this Plan to their detriment

NORTH

TERRACE

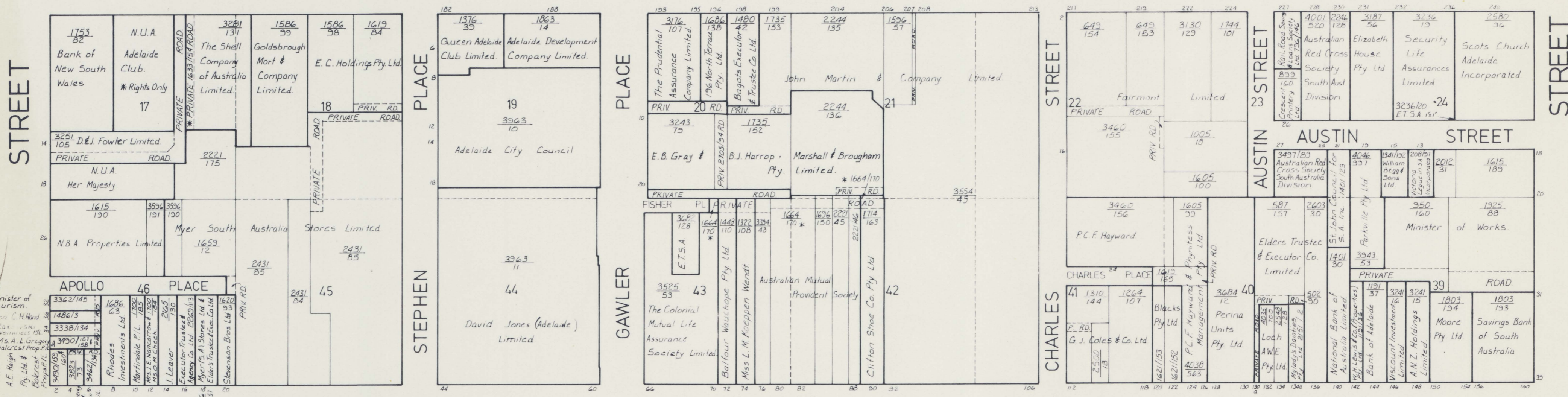

RUNDLE

MALL

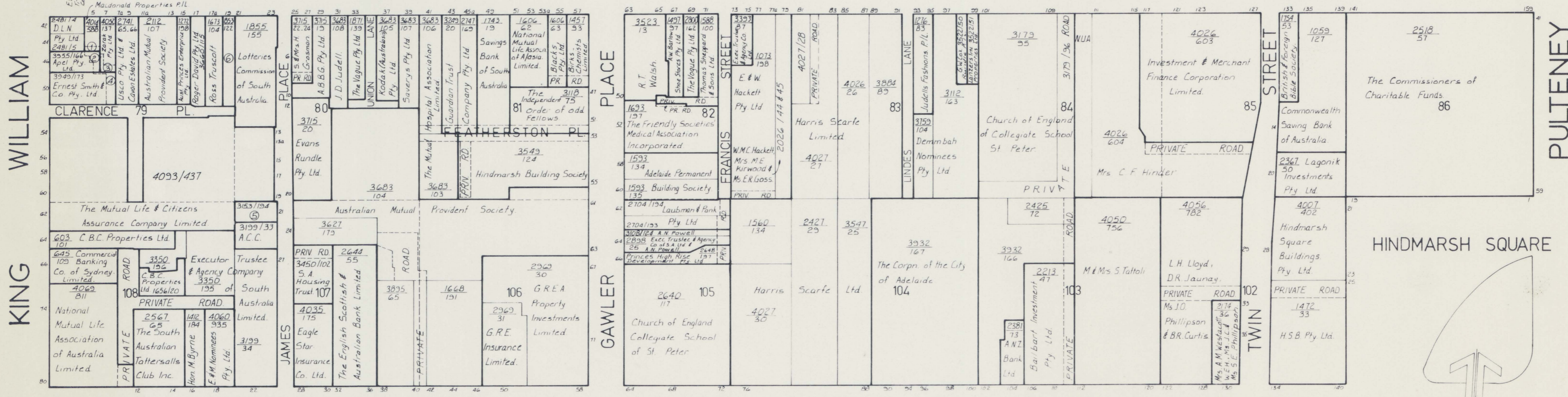

GRENFELL

STREET

CITY OF ADELAIDE  
PROPERTY OWNERSHIP  
SCALE - 1:1000  
CITY PLANNER'S DEPT.  
8 - 1977

- ① 4014/587
- ② 3955/165
- ③ 4052/136
- ④ 3949/172
- ⑤ Mrs H.B. Morrow, J.K. Everett & J. Sinclair
- ⑥ The Perpetual Executors & Trustees Association Australia Limited

