

The Corporation of the City of Adelaide does not warrant that the areas, measurements and sitings specified or appearing on this Plan are a true and accurate record and the Corporation accepts no responsibility to persons relying or acting on the accuracy of anything contained in this Plan to their detriment.

VICTORIA SQUARE

ANGAS STREET

STREET

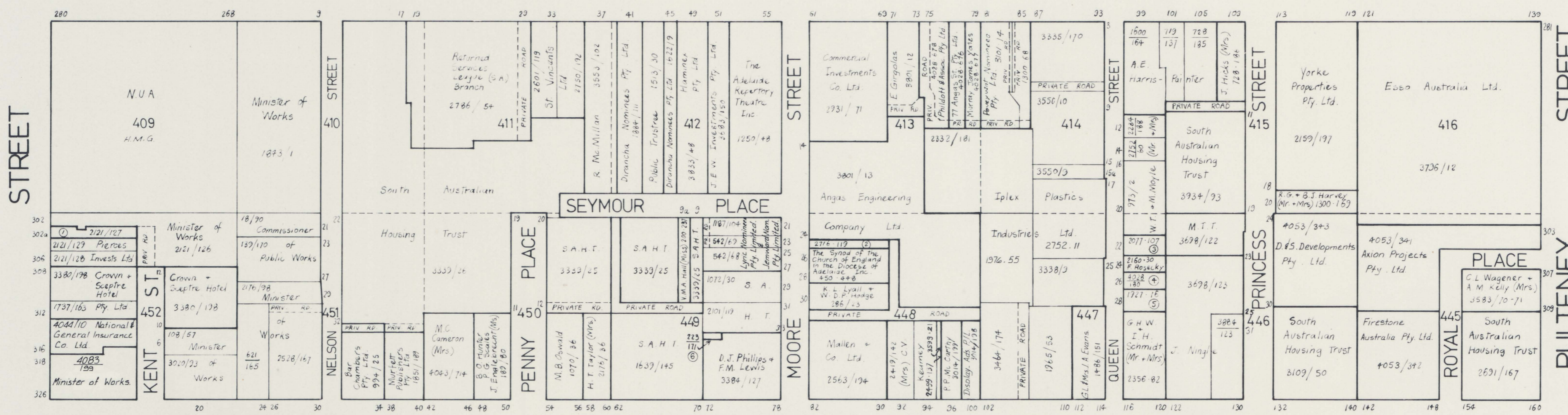

CARRINGTON STREET

STREET

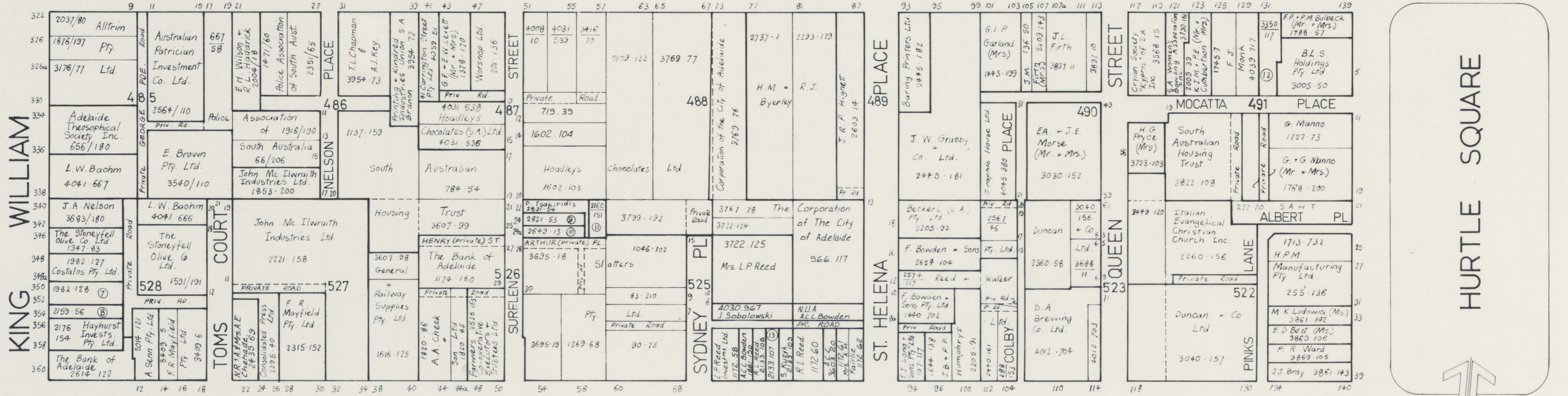

HALIFAX STREET

STREET

- ① S + C Sagaras (Mr. + Mrs.)
- ② K. M. Lindsay
- ③ S.E.D. Gould & Ms. H.V. Virgo
- ④ A.C.J. Walker + D.J. Sleeman
- ⑤ G.H.W. + I.H. Schmidt (Mr. + Mrs.)
- ⑥ S. Chapman
- ⑦ The Church Missionary Society of Tasmania, S.A. Branch
- ⑧ V. + I. Baccussini (Mr. + Mrs.)
- ⑨ G. + S. Despinoudis (Mr. + Mrs.)
- ⑩ R. + G. Fausin (Mr. + Mrs.)

- ⑪ J. Karolewicz
- ⑫ Aged + Invalid Pensioners Association of S.A. Inc.
- ⑬ K.J. & Mrs. C.S. + Robertson

CITY OF ADELAIDE
PROPERTY OWNERSHIP