

The Corporation of the City of Adelaide does not warrant that the areas, measurements and sitings specified or appearing on this Plan are a true and accurate record and the Corporation accepts no responsibility to persons relying or acting on the accuracy of anything contained in this Plan to their detriment.

WHITMORE SQUARE

STURT STREET

STREET

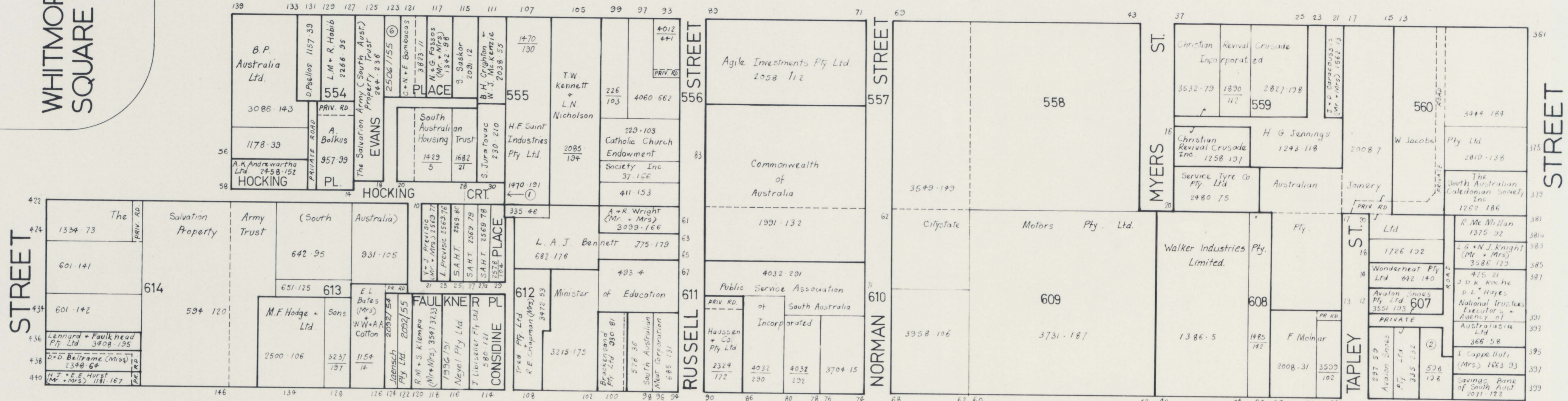

GILBERT STREET

STREET

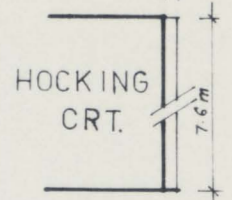
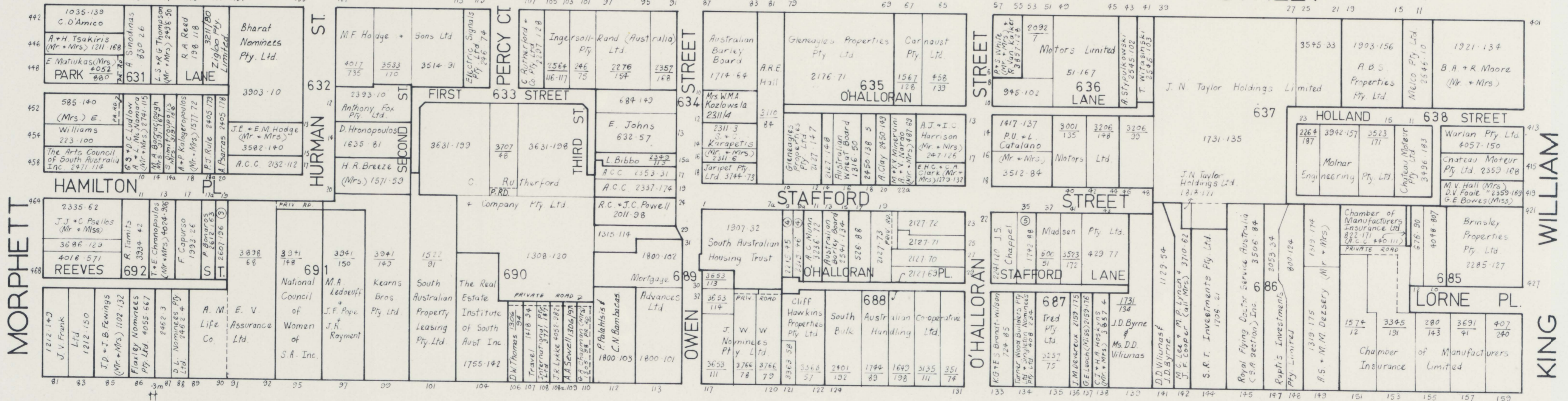

SOUTH TERRACE

TERRACE



CITY OF ADELAIDE PROPERTY OWNERSHIP

- ① H.F. Saint Industries Proprietary Limited
- ② G.A.Tsarouchias P.M. Ludos (both Mr. + Mrs.)
- ③ L.A. Boerema (Mrs.) M.D. Boerema D.R. Hamilton
- ④ Glenrussell Estates Pty. Ltd.
- ⑤ Turner Wood Builders Pty. Ltd & J.S. Chappel
- ⑥ The Salvation Army (South Australia) Property Trust

SCALE - 1:1000

CITY PLANNER'S DEPT.