

Charles Clarke & about 230 acres ✓
 George Ellis X

GAMBIER

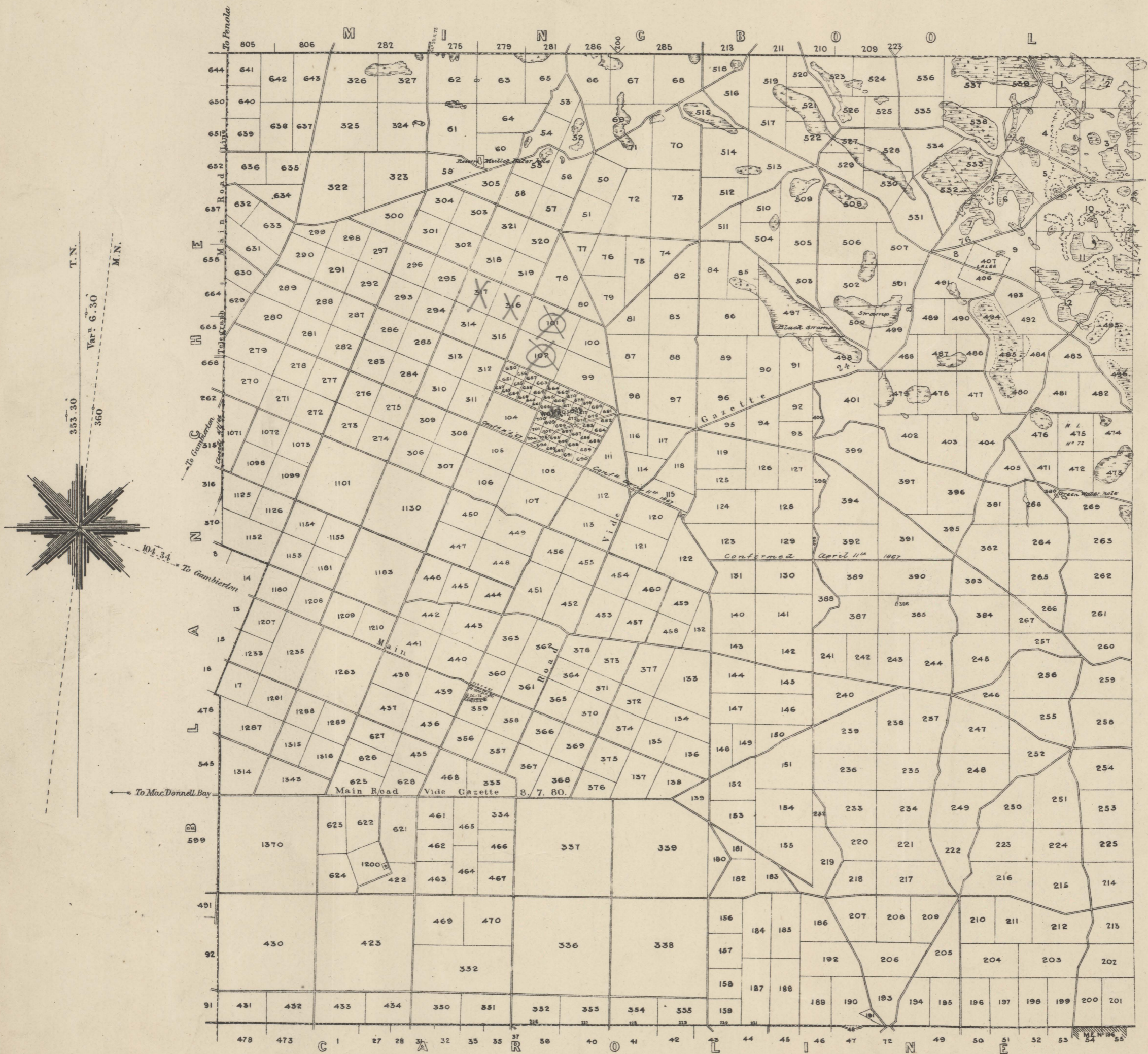

T. N. 355.30
 Var. 6.30
 M. N. 360

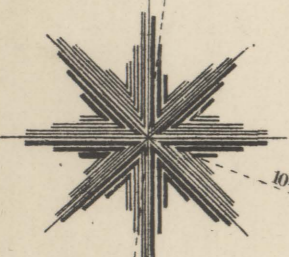

—SCALE—
 Chains 0 20 40 60 80 100 120 140 160 180 200
 Miles 0 1 2 3 4 5
 SURVEYOR GENERAL'S OFFICE, ADELAIDE. Fraser & Crawford, Photo-lithographers.
 OCTOBER 1882

OFFICIAL

GAMBIER