

# KOOLUNGA

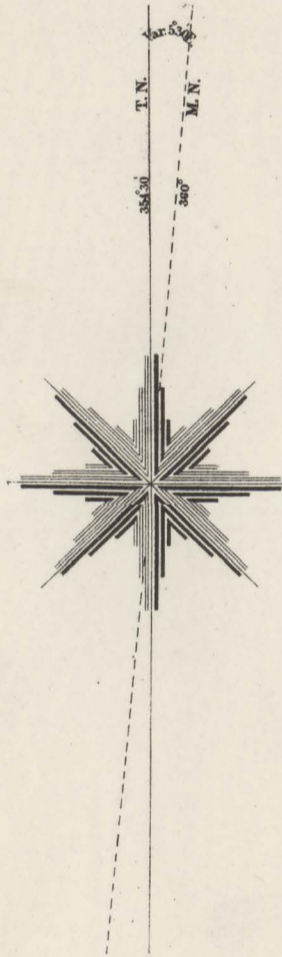

—SCALE—  
Chains — 80 70 60 50 40 30 20 10 0 10 20 30 40 50 60 70 80 — Chains  
Drawn by J. W. W. (1196) Examined by G. M. C.  
SURVEYOR GENERAL'S OFFICE, ADELAIDE. Fraser S. Crawford, Photo-lithographer.  
JUNE 1879

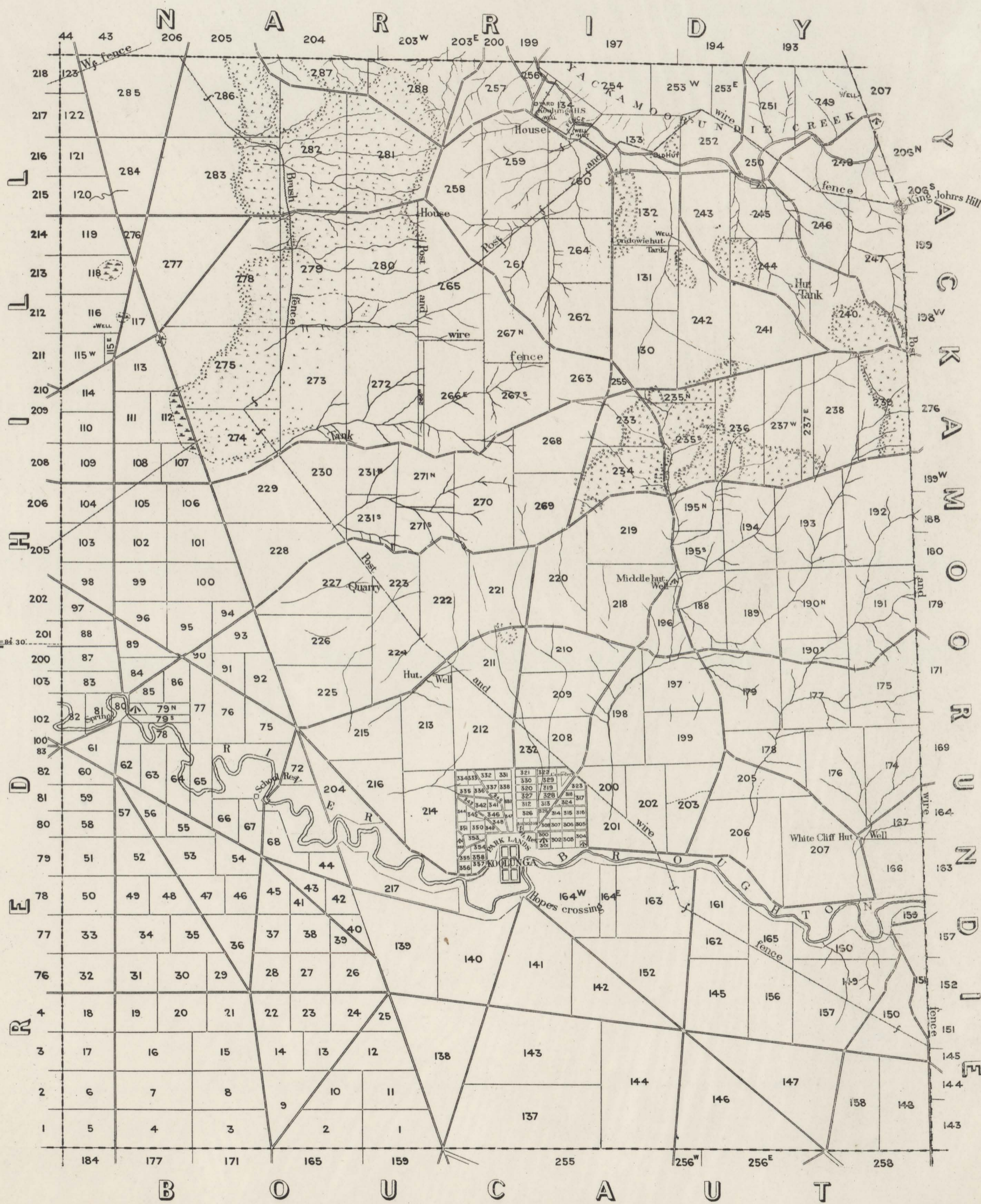