

NEALES

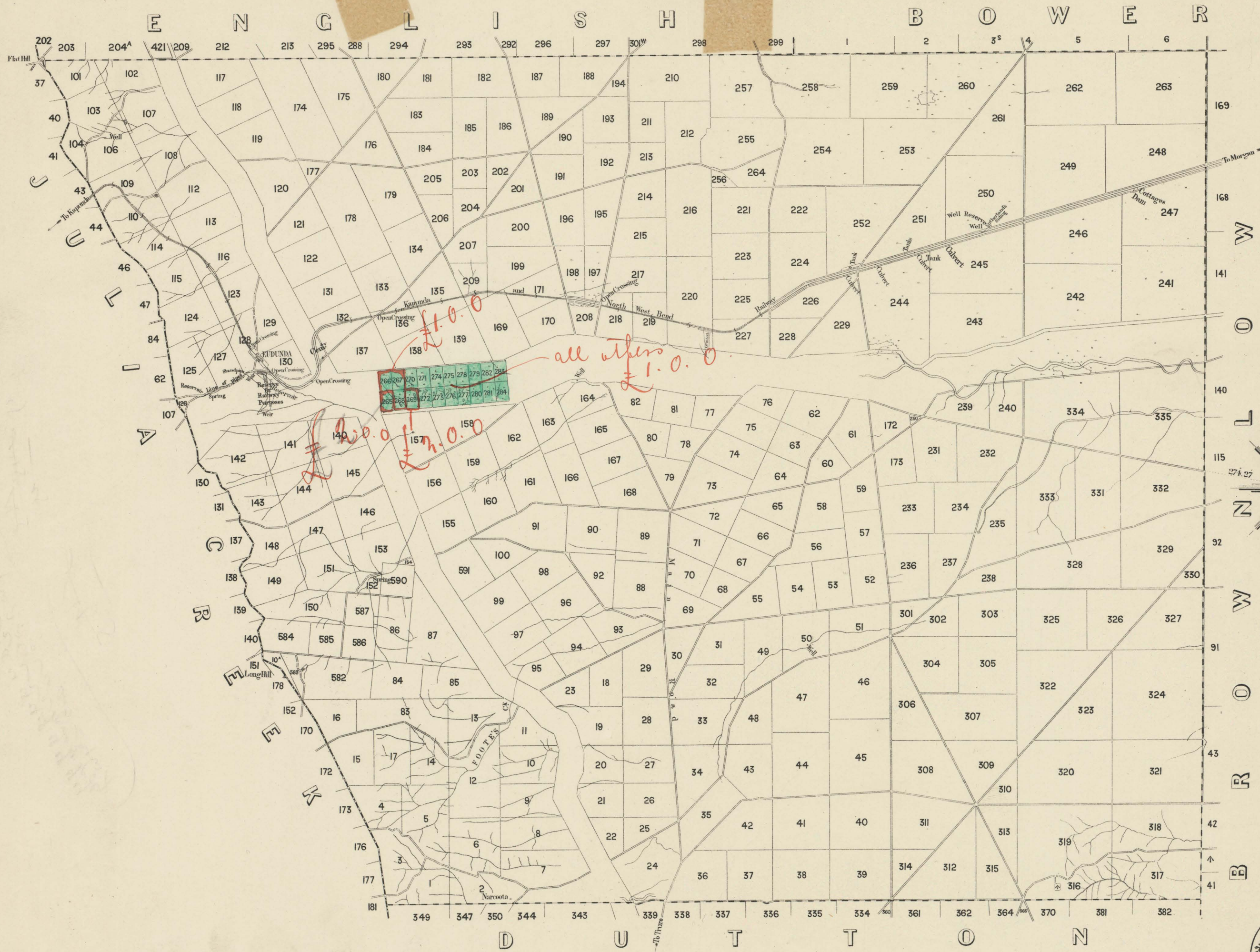

Chains 80 70 60 50 40 30 20 10 0 — SCALE — 0 10 20 30 40 50 60 70 80 Chains
Miles 1/2 1 1 1/2 2 2 1/2 3 3 1/2 4 4 1/2 5 Miles
(5023)
SURVEYOR GENERAL'S OFFICE, ADELAIDE. Fraser S. Crawford, Photo-lithographer.
AUGUST 1887



NEALES