

ULYERRA CO MUSGRAVE

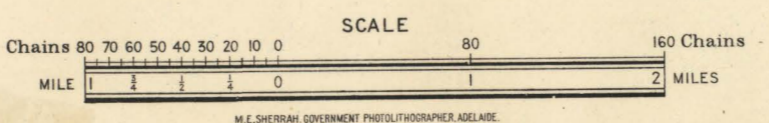
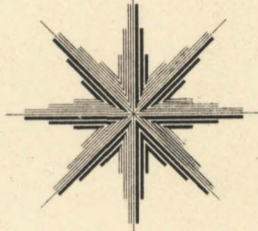
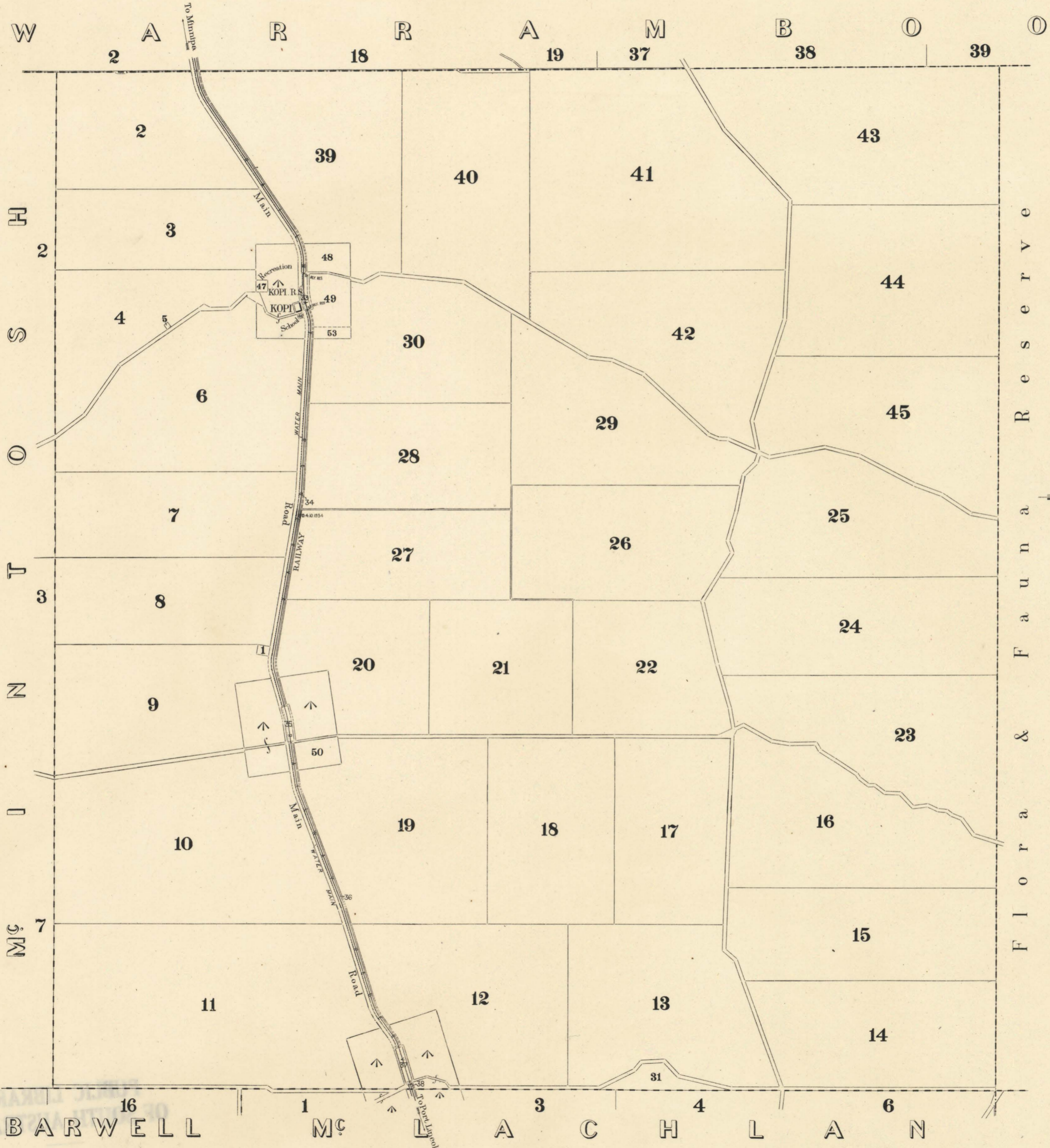

M.E. SHERRAH, GOVERNMENT PHOTOGRAPHER, ADELAIDE, 1952

COMPILED IN THE OFFICE OF THE SURVEYOR GENERAL, DEPARTMENT OF LANDS

H
830 bje
1:63,360
Ulyerra
1952

Ulyerra