

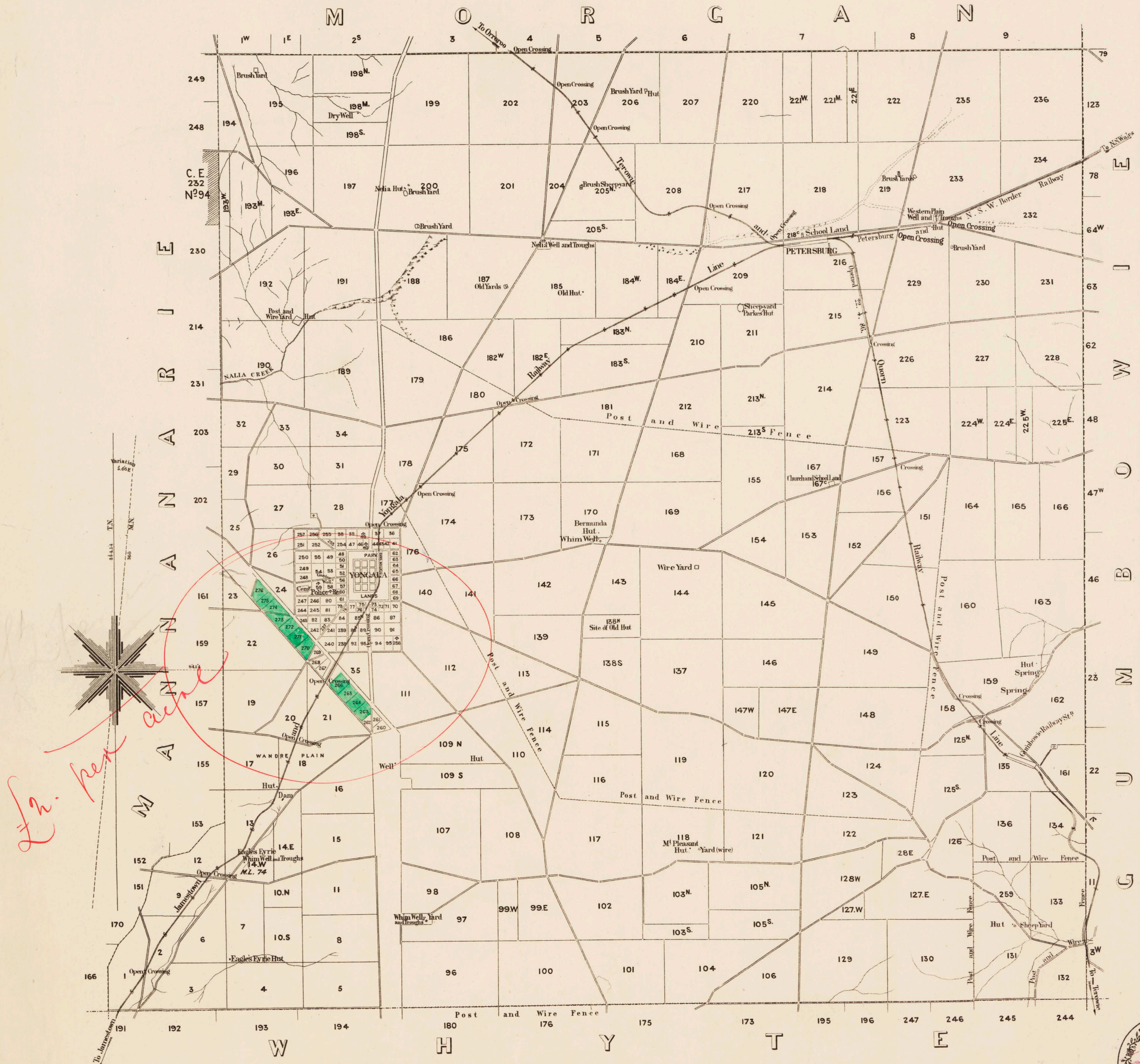

# YONGALA



— SCALE —  
 Chains 80 70 60 50 40 30 20 10 0 80 160  
 Miles 1/2 1 1 1/2 2 2 1/2 3 3 1/2 4 4 1/2 5 5 1/2 6 6 1/2 7 7 1/2 8 8 1/2 9 9 1/2 10  
 (3920)  
 SURVEYOR GENERAL'S OFFICE, ADELAIDE. *Præpar. S. Crawford, Photo-lithographer*  
 AUGUST 1886



# YONGALA